



RoboSep™ Buffer Bottle Adapter

Catalog #20113



Scientists Helping Scientists™ | WWW.STEMCELL.COM

TOLL FREE PHONE 1 800 667 0322 • PHONE +1 604 877 0713

INFO@STEMCELL.COM • TECHSUPPORT@STEMCELL.COM

FOR GLOBAL CONTACT DETAILS VISIT OUR WEBSITE

FOR RESEARCH USE ONLY. NOT INTENDED FOR HUMAN OR ANIMAL DIAGNOSTIC OR THERAPEUTIC USES.

Product Description

The RoboSep™ Buffer Bottle Adapter needs to be installed in RoboSep™ (Catalog #20000) so that the square RoboSep™ Buffer Bottle (Catalog #20104) will properly fit.

The RoboSep™ Buffer Bottle Adapter can be removed and cleaned as needed. To maintain the white foam padding of the adapter, avoid the use of bleach or strong detergents when cleaning the adapter.

Installing the Adapter on RoboSep™

1. Ensure that the RoboSep™ buffer bottle compartment is clean and dry.

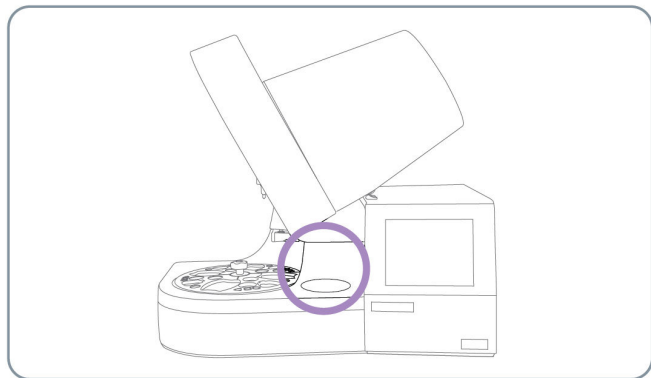

2. Insert the RoboSep™ Buffer Bottle Adapter into the buffer bottle compartment so that the white foam padding is facing down and the wider face is positioned towards the front of the unit.

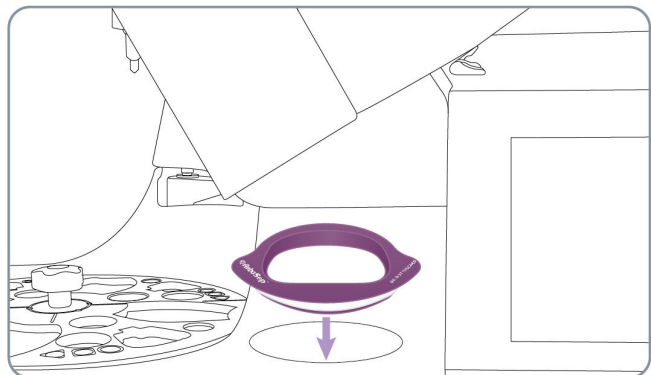

Placing the RoboSep™ Buffer Bottle

When setting up a run in RoboSep™, place the square RoboSep™ Buffer Bottle in the adapter.

NOTE: The bottle will still be able to move slightly. This is normal and will not affect the performance of RoboSep™.

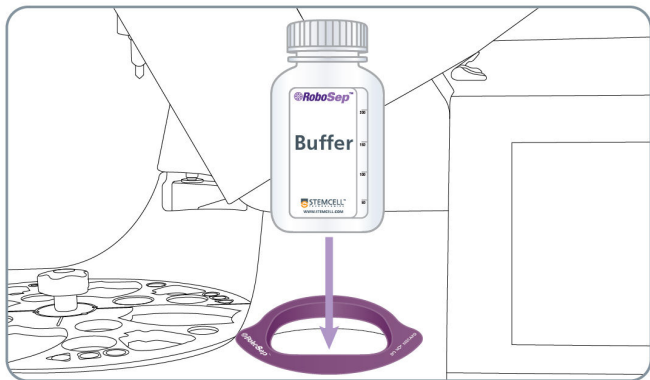

STEMCELL TECHNOLOGIES INC.'S QUALITY MANAGEMENT SYSTEM IS CERTIFIED TO ISO 13485 MEDICAL DEVICE STANDARDS.

Copyright © 2015 by STEMCELL Technologies Inc. All rights reserved including graphics and images. STEMCELL Technologies & Design, STEMCELL Shield Design, Scientists Helping Scientists, and RoboSep are trademarks of STEMCELL Technologies Inc. All other trademarks are the property of their respective holders. While STEMCELL has made all reasonable efforts to ensure that the information provided by STEMCELL and its suppliers is correct, it makes no warranties or representations as to the accuracy or completeness of such information.